

JBC

www.jbctools.com

INSTRUCTION MANUAL



FL

Refillable Brush Pen for
Flux Application

This manual corresponds to the following reference:

FL-A

Packing List

The following items are included:

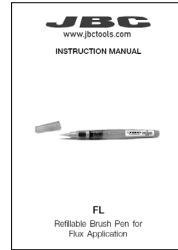

Refillable Brush Pen for Flux Application 1 unit

Manual 1 unit
Ref. 0031374

Note: FL is supplied without flux.

Features

FL is a refillable brush pen designed to be used with flux in the preparation of printed circuits prior to soldering SMD components. Especially used for flat pack integrated circuits.

Note: The FL container is supplied empty and must be filled with liquid flux before using it. The container has a capacity of 5.5 ml.

JBC brush pens have a retractable valve that gives complete control over how much flux is released.

How to use FL

All you need to do before use is fill the container with liquid flux.

To do so, unscrew the brush cap from the barrel (1). Then remove the sealing cap that seals the flux in the barrel (2).

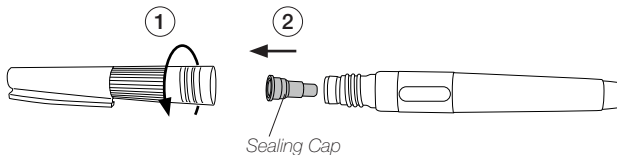

Completely fill the brush pen container with flux (3) and re-seal it with the sealing cap (2).

To refill, use for example JBC's FL50, a flux bottle with 500 ml flux and a useful flexible nozzle (4) which helps to refill small containers.

Note: Although residues of JBC's flux are minimal, they are water soluble for those cases where thorough cleaning is required.

Prior to flux application, clean and degrease the surface to be soldered.

Gently squeeze the flexible container (5) until the desired amount of flux comes out.
Do the solder joint.

The incorporated retractable valve gives complete control over how much flux is released.

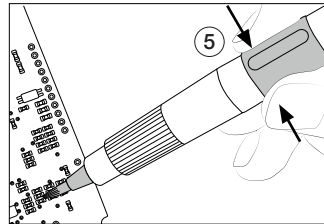
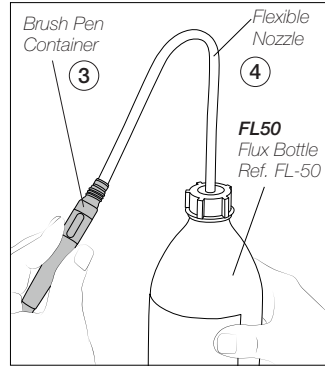

Safety

Follow the flux supplier's safety recommendations.

Safety recommendations for JBC's FL50 Flux can be found in its instruction manual and at www.jbctools.com.

Specifications

FL
Refillable Brush Pen for Flux Application
Ref. **FL-A**

- | | |
|---|---|
| - Barrel: | Capacity: 5.5 ml / 0.186 floz
Refillable |
| - Net Weight: | 6.5 g / 0.014 lb |
| - Package Dimensions/Weight:
(W x L x H) | 170 x 21 x 21 mm / 16 g
6.69 x 0.83 x 0.83 in / 0.035 lb |

JBC

Warranty

JBC's 2 year warranty covers this equipment against all manufacturing defects, including the replacement of defective parts and labour.

Warranty does not cover product wear or misuse.

In order for the warranty to be valid, equipment must be returned, postage paid, to the dealer where it was purchased.



This product should not be thrown in the garbage.

In accordance with the European directive 2012/19/EU, electronic equipment at the end of its life must be collected and returned to an authorized recycling facility.



www.jbctools.com