

# JBC

[www.jbctools.com](http://www.jbctools.com)

## INSTRUCTION MANUAL



# PK

Pick and Place Unit

This manual corresponds to the following reference:

**PK-5A**

# Packing List

The following items are included:



**Pick and Place Module**  
..... 1 unit



**Pick and Place Handle** ..... 1 unit



**Pedal** ..... 1 unit  
Ref. P-405



**CU260 Cups Set**  
..... 1 unit  
Ref. 0940163

- Ø 4.3 mm - 0940112 (x2)
- Ø 7 mm - 0940111 (x2)
- Ø 10 mm - 0940110 (x2)



**NB260 Bent Needles Set** ..... 1 unit  
Ref. 0861660

- Ø 0.51 mm - 0025117 (x2) violet
- Ø 0.61 mm - 0025119 (x2) pink
- Ø 0.84 mm - 0025121 (x2) green



**NS260 Straight Needles Set** ..... 1 unit  
Ref. 0901546

- Ø 0.41 mm - 0025110 (x2) blue
- Ø 0.51 mm - 0025112 (x2) violet
- Ø 0.84 mm - 0025114 (x2) green



**Paper Filter Box** ..... 1 unit  
Ref. 0005966  
*It contains 50 filters.*



**Power Adapter** ..... 1 unit  
Ref. 0033723



**Manual** ..... 1 unit  
Ref. 0024027

## Features and Connections

PK-5A is a vacuum unit which allows easy positioning and removal of SMD components of different sizes.

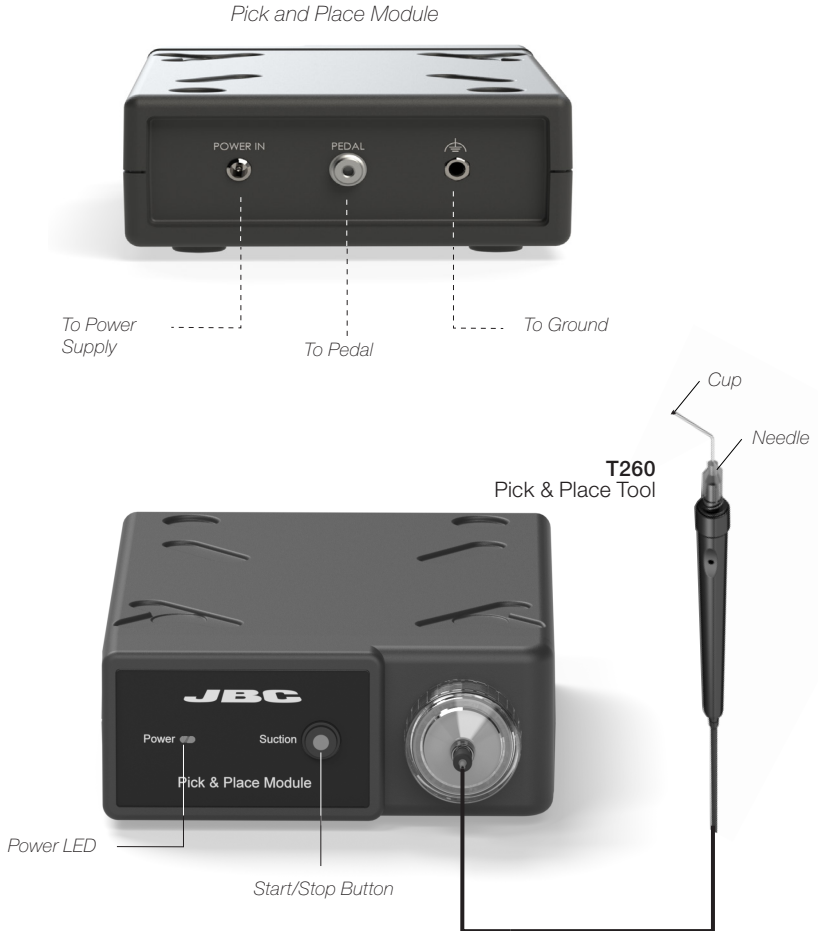

## Tool Assembly

Once the tool is connected to the suction module, insert a needle and attach the appropriate cup for a correct suction process.

Make sure the needle does not protrude from the cup.

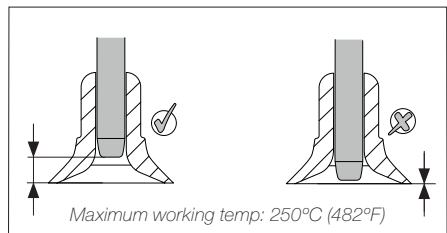

# Operation modes

It features two drive modes: a continuous mode for the removal of components with extractors/tri-pods, and another mode with activation via pedal for precision work with the handpiece.

## a) Hand control

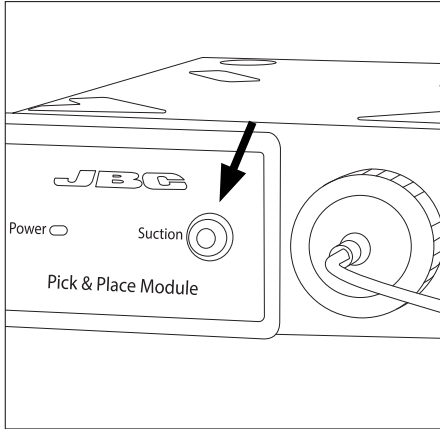

Press the suction button to activate or stop the suction.

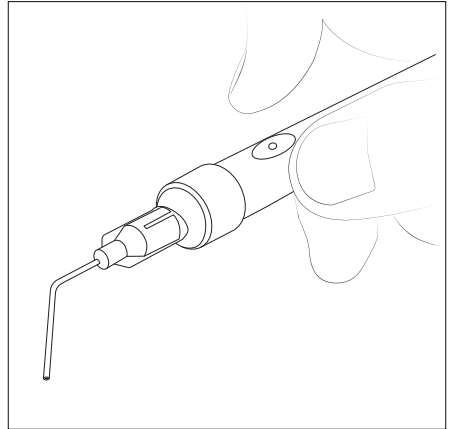

Hold the pen so that the hole is accessible to your finger tip.

### Suction

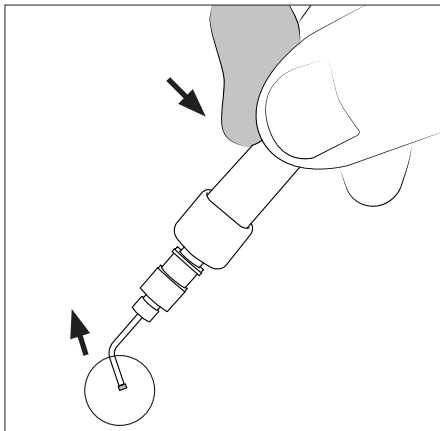

Cover the pen hole with your finger and lift off the component.

### Release

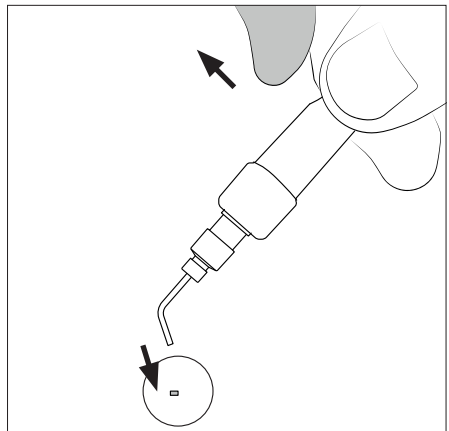

Lift your finger to release the component.

**b) Pedal control**

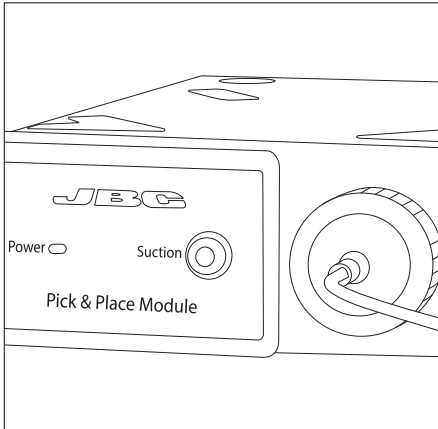

Keep suction button off to allow pedal function.

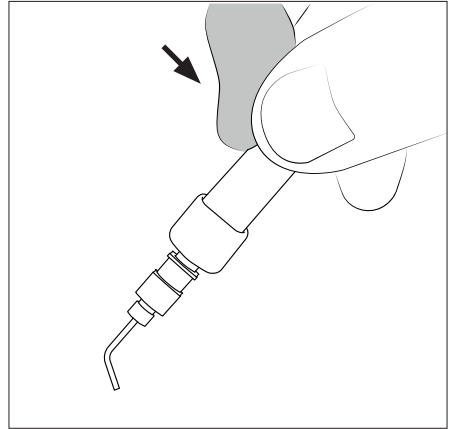

Keep your finger on the pen hole.

**Suction**

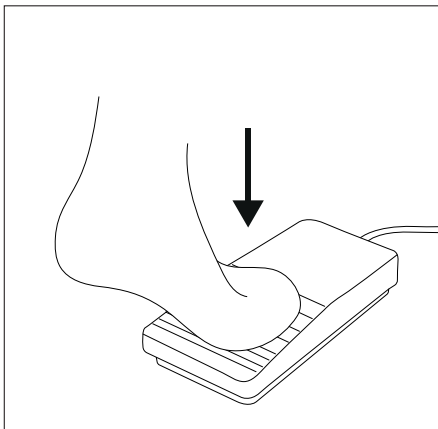

Press the pedal to start the suction.

**Release**

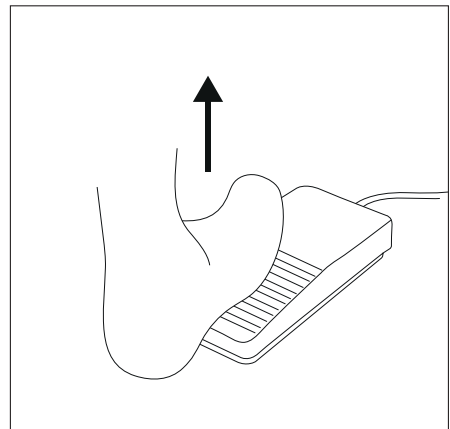

Lift your foot to release the component.

# Maintenance

Before carrying out maintenance or storage, always unplug the equipment.

- Keep the casing clean by using a damp cloth. Use a soft cloth when cleaning the front side.
- Periodically check all cable and tube connections.
- Keep filters clean to ensure proper suction and replace them when necessary.



- Use original JBC spare parts only.
- Do not work with defective or damaged pieces.
- Repairs should only be performed by a JBC authorized technical service.
- Maintenance must not be carried out by children unless supervised.

## Safety



**It is imperative to follow safety guidelines to prevent electric shock, injury, fire or explosion.**

- Do not use the units for any purpose other than soldering or rework. Incorrect use may cause fire.
- The power cord must be plugged into approved bases. Be sure that it is properly grounded before use. When unplugging it, hold the plug, not the wire.
- Do not work on electrically live parts.
- Do not leave the appliance unattended when it is on.
- Do not cover the ventilation grills. Heat can cause inflammable products to ignite.
- Avoid flux coming into contact with skin or eyes to prevent irritation.
- Be careful with the fumes produced when soldering.
- Keep your workplace clean and tidy. Wear appropriate protection glasses and gloves when working to avoid personal harm.
- Utmost care must be taken with liquid tin waste which can cause burns.
- This appliance can be used by children over the age of eight and also persons with reduced physical, sensory or mental capabilities or lack of experience provided that they have been given adequate supervision or instruction concerning use of the appliance and understand the hazards involved. Children must not play with the appliance.

# Specifications

## PK

### Pick & Place Unit

#### Ref. PK-5A

- Package Dimensions / Weight: 145 x 55 x 225 mm / 1.7 kg  
(L x W x H) 5.71 x 2.17 x 8.86 in / 3.8 lb
- Vacuum: 55 % / 418 mm Hg / 16.4 in Hg
- Ambient operating temperature: 10 - 50 °C / 50 - 104 °F
- Pedal connection: Yes

Complies with CE standards.  
ESD protected.

# JBC

## Warranty

JBC's 2 year warranty covers this equipment against all manufacturing defects, including the replacement of defective parts and labor.

Warranty does not cover product wear or misuse.

In order for the warranty to be valid, equipment must be returned, postage paid, to the dealer where it was purchased.

**Get 1 extra year JBC warranty by registering here:**  
<https://www.jbctools.com/productregistration/>  
**within 30 days of purchase.**

If you register, you will receive e-mail notifications about new software updates for your registered product.



This product should not be thrown in the garbage.

In accordance with the European directive 2012/19/EU, electronic equipment at the end of its life must be collected and returned to an authorized recycling facility.

CE EAC UK  
CA

[www.jbctools.com](http://www.jbctools.com)

0024027-250624