

# **JBC**

[www.jbctools.com](http://www.jbctools.com)

## **INSTRUCTION MANUAL**

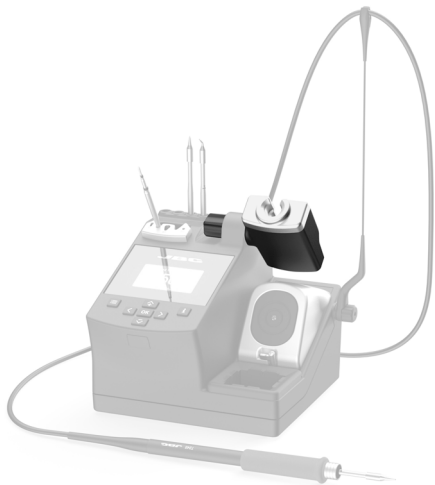

**H2994, H4706,  
H4720, H4719**

Tool Holders for  
Compact Stations

This manual corresponds to the following references:

**0012994** - H2994 for CDS & CDB, CDES & CDEB Stations

**0014706** - H4706 for CA and CF Stations

**0014720** - H4720 for CS Stations

**0014719** - H4719 for CP Stations

## Packing List

The following items are included:



**Tool Holder** ..... 1 unit  
*according to purchased reference*

**Manual** ..... 1 unit  
Ref. 0028656

## Replacement



Before carrying out maintenance, always unplug the tool. Allow the equipment to cool down. Be sure that the power supply is disconnected before changing any spare part.

## Changing the Tool Holder

Turn the station off and allow the equipment to cool down.

Remove the locking knob (1) and slightly separate the holder from the station (max. 15 mm). Then remove the connection screw (2).

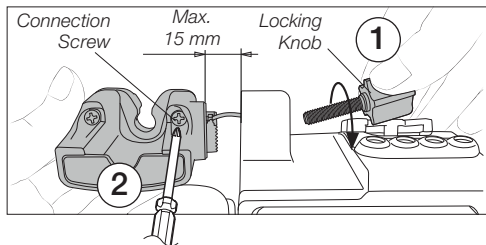

Using a flat-blade screwdriver, guide the cable connector outward to completely detach the support from the station.

⚠ Any force exerted for extraction must be applied on the connector, never on the cable.

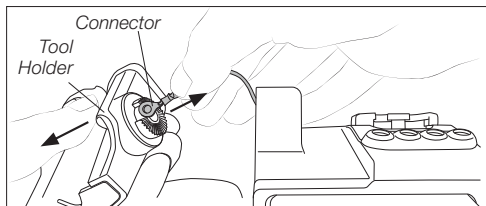

Insert the connector in the new holder, put it in place and follow steps 1 and 2 conversely.

# Specifications

## **H2994, H4706, H4720, H4719**

### **Tool Holders for Compact Stations**

Ref.: **0012994** *H2994 for CDS & CDB, CDES & CDEB Stations*

Ref.: **0014706** *H4706 for CA and CF Stations*

Ref.: **0014720** *H4720 for CS Stations*

Ref.: **0014719** *H4719 for CP Stations*

- Package Dimensions:            111 x 81 x 41 mm  
(L x W x H)                            4.37 x 3.19 x 1.61 in

Complies with CE standards  
ESD Safe

# **JBC**

## **Warranty**

JBC's 2 year warranty covers this equipment against all manufacturing defects, including the replacement of defective parts and labour.

Warranty does not cover product wear or misuse.

In order for the warranty to be valid, equipment must be returned, postage paid, to the dealer where it was purchased.



This product should not be thrown in the garbage.

In accordance with the European directive 2012/19/EU, electronic equipment at the end of its life must be collected and returned to an authorized recycling facility.



[www.jbctools.com](http://www.jbctools.com)